

EMP-710/700/500 Exploded Diagram

December 25th, 1999
VDCSG, SEIKO EPSON

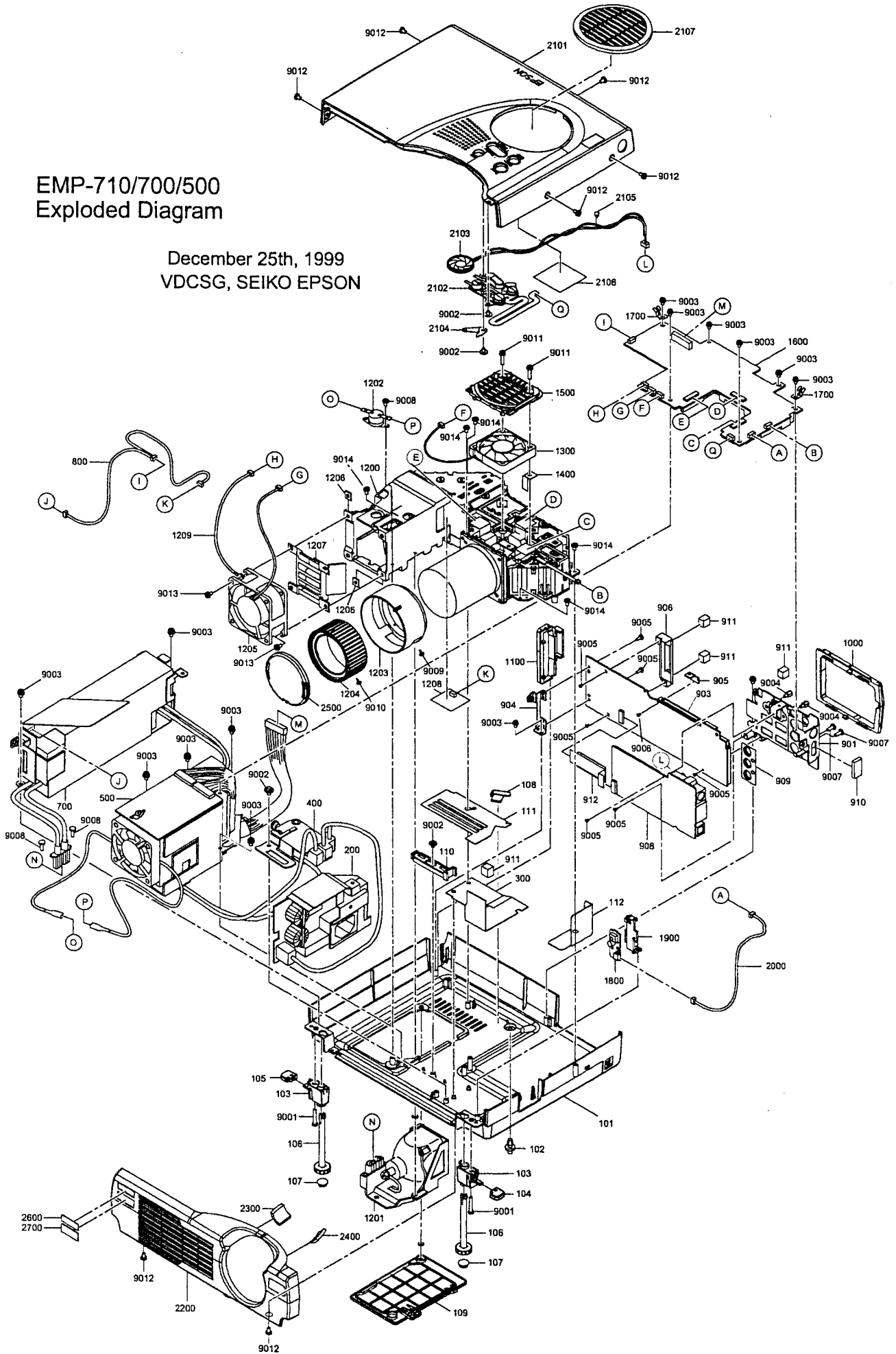

1) Contents of the set

Symbol	Contents	Qty.	Note
①	Projector	1	
②	Soft Bag	1	PE 320×400 t=1.0
③	Polyethylene Bag	1	HDPE 340×400 t=0.05
④	Caution Sheet	1	
⑤	Accessory Box	1	
⑥	Soft case	1	
⑦	Individual Box	1	
⑧	Lower plate	1	
⑨	Lower pad	1	
⑩	Ecology sheet	1	
⑪	Inner Sheet	1	
⑫	Remote Control Unit	1	
⑬	Audio/Visual Cable	1	
⑭	Power Supply Cable	1	
⑮	Battery	1	Alkali dry cell (2Pieces)
⑯	Computer Cable	1	
⑰	Mouse Cable Set	1	PS/2 mouse cable, ADB mouse cable, USB mouse cable within polyethylene bag
⑱	Instruction Manual set	1	Instruction Manual, Registration card, Inf. of Load service, Declaration of FCC conformity, Quick reference card within polyethylene bag
⑲	Telephone Card set	1	Within envelope
⑳	Serial NO. Label A	1	Made of 2 sheet
㉑	UPC Code Label	1	

※ The way of giving Serial No.: (11 figures)

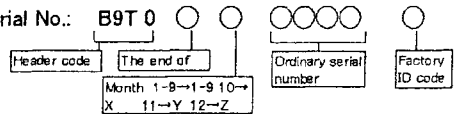

2) Packing

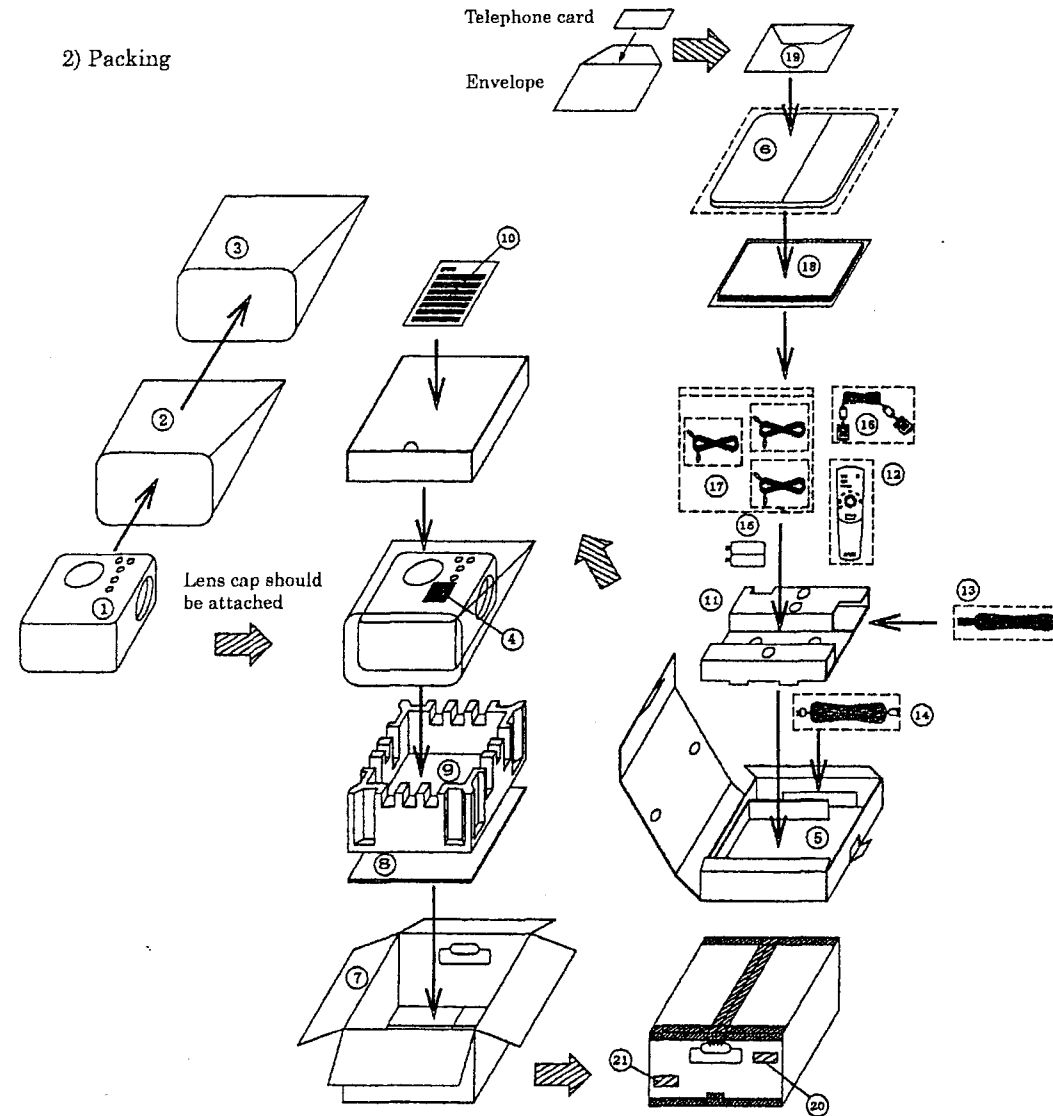

Figure 2 Packing specification

图 2 捆包形态图